



# PORTO LAGO

APARTAMENT

NR **419**



Działka Nr 168/1  
Serock

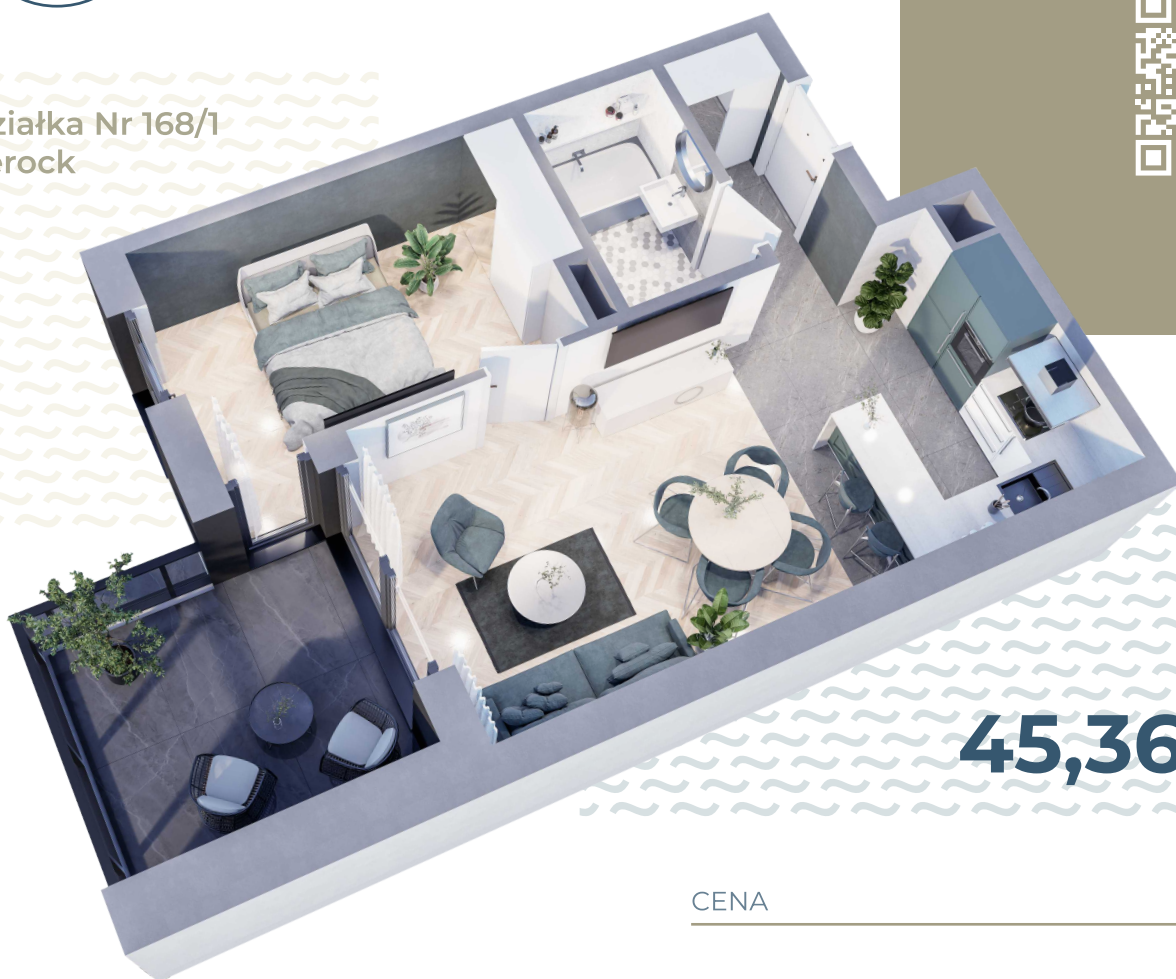

## 45,36 m<sup>2</sup>

CENA

### BUDYNEK 1 KLATKA B

- |                              |                            |
|------------------------------|----------------------------|
| 1. Pokój z aneksem kuchennym | <b>26,00 m<sup>2</sup></b> |
| 2. Pokój                     | <b>11,73 m<sup>2</sup></b> |
| 3. Hol                       | <b>3,40 m<sup>2</sup></b>  |
| 4. Łazienka                  | <b>4,23 m<sup>2</sup></b>  |

**45,36 m<sup>2</sup>**

### PIĘTRO 3

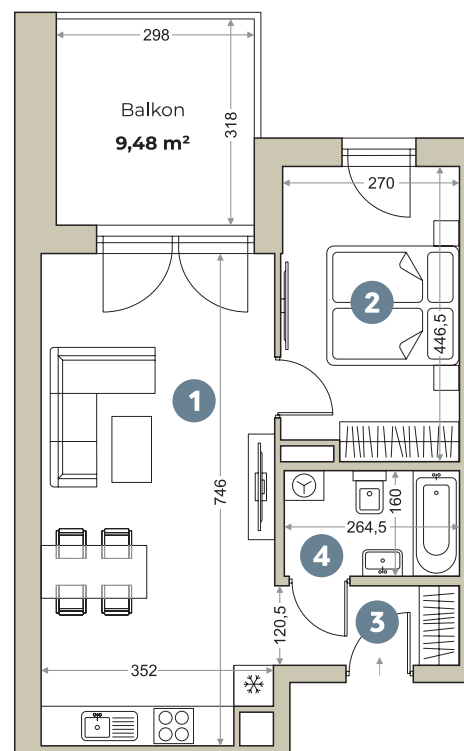



PORTO LAGO

